

Howard Street at the North Branch Trail Crossing
 Safety Improvements – Rectangular Rapid Flashing Beacons _ Decorative High Visibility Crosswalk _ Raised Median and Refuge Island _ Improved Signage

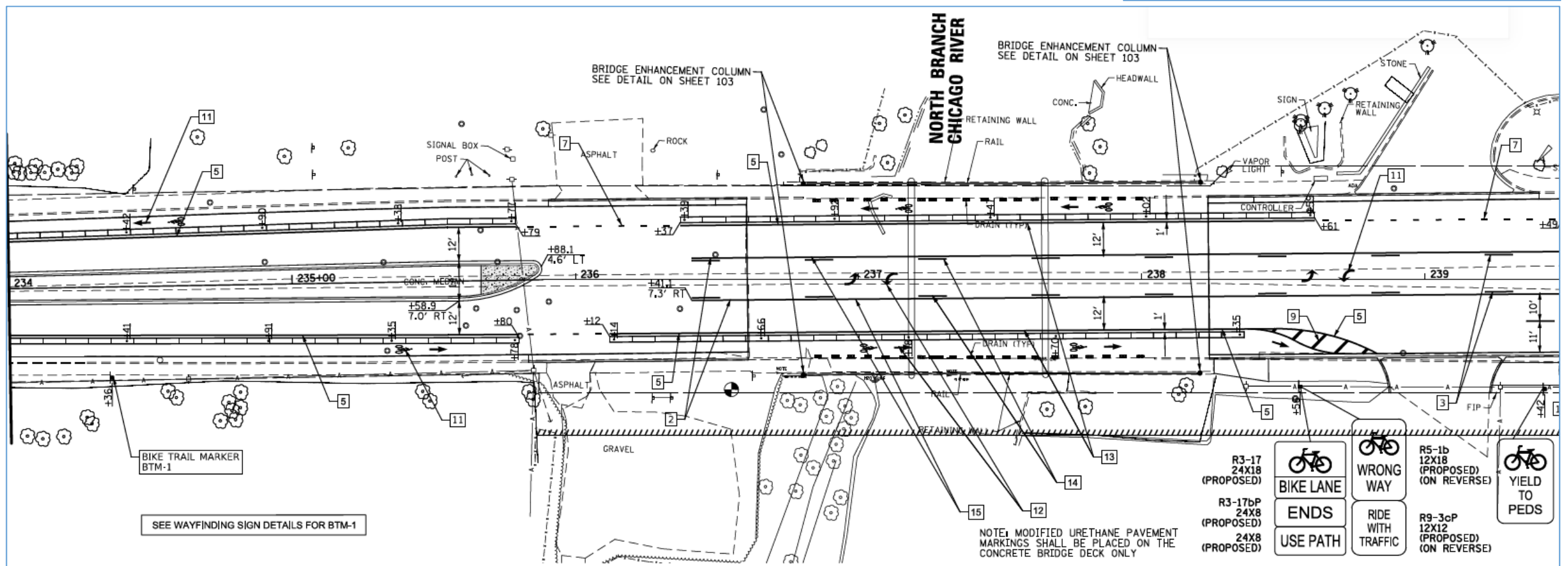
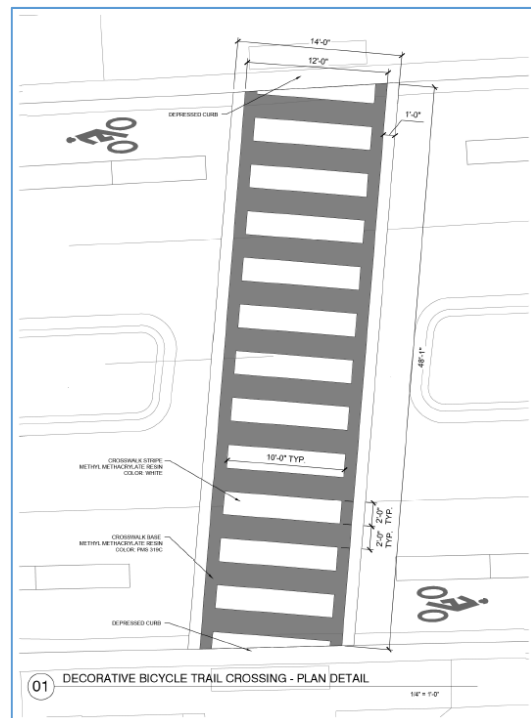
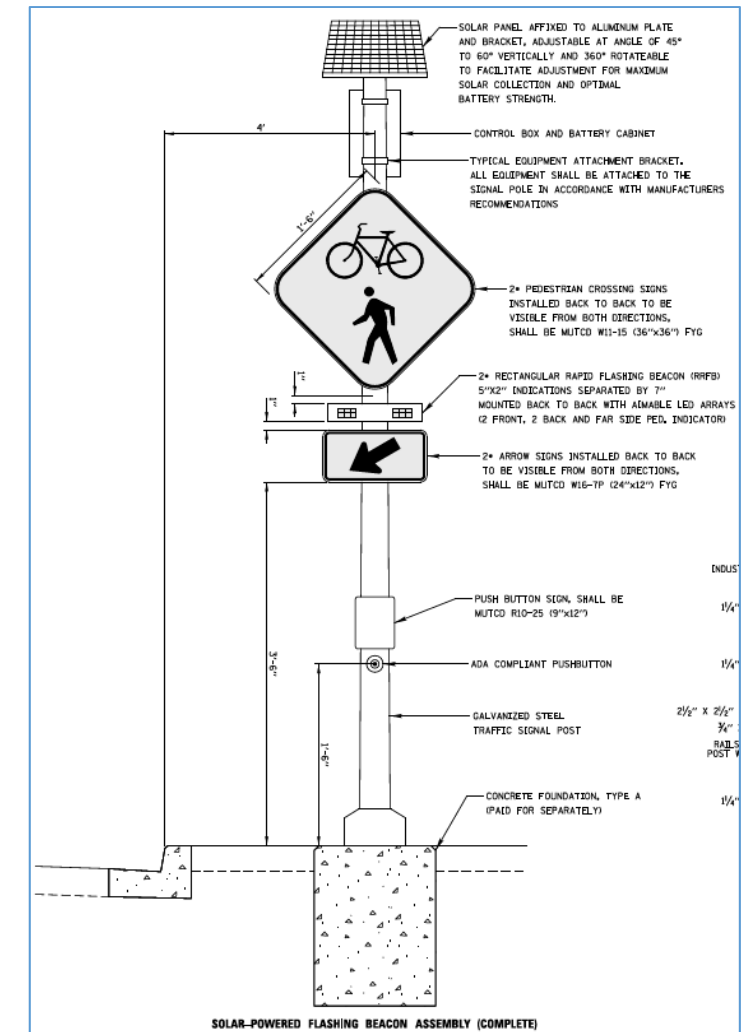
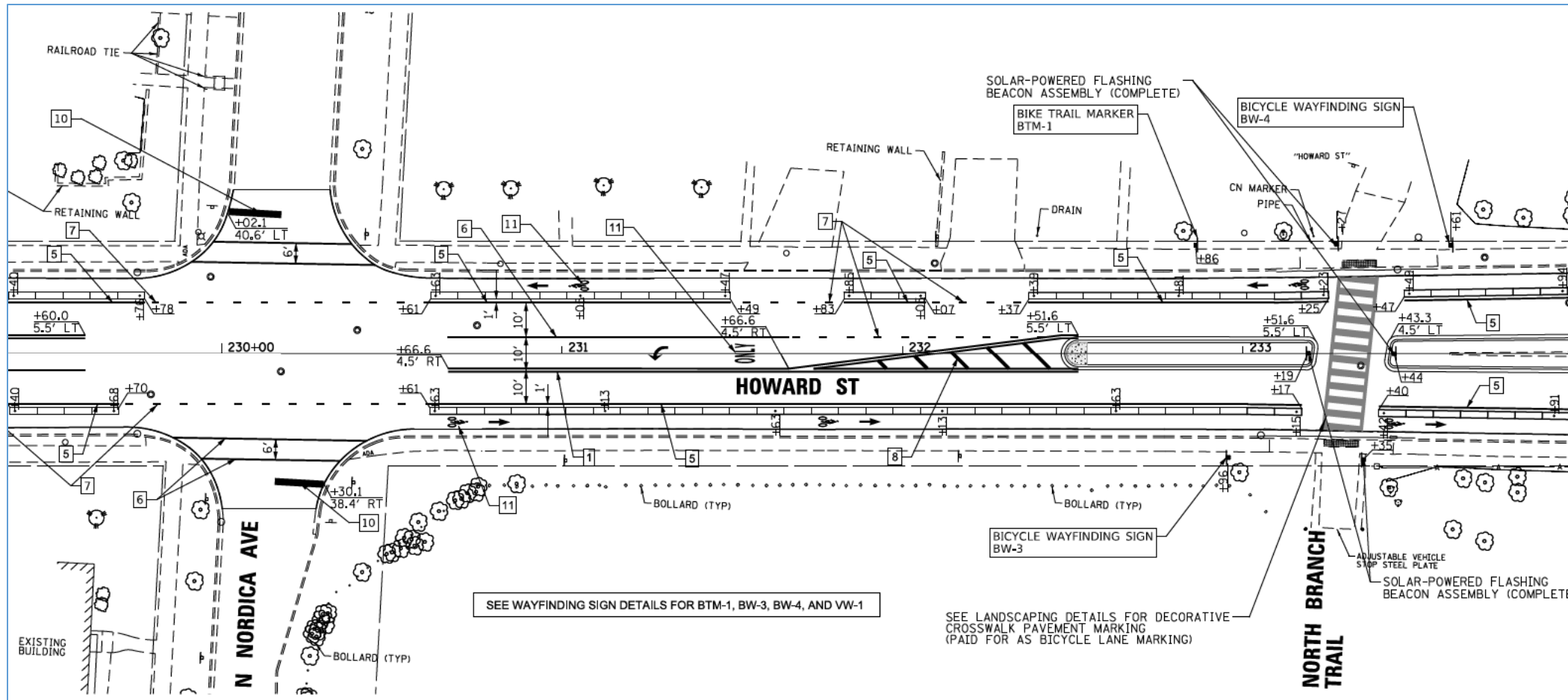

- R3-17 24X18 (PROPOSED) BIKE LANE
- R3-17bP 24X8 (PROPOSED) USE PATH
- R5-1b 12X18 (PROPOSED) (ON REVERSE) WRONG WAY
- R9-3cP 12X12 (PROPOSED) (ON REVERSE) RIDE WITH TRAFFIC
- YIELD TO PEDS

NOTE: MODIFIED URETHANE PAVEMENT MARKINGS SHALL BE PLACED ON THE CONCRETE BRIDGE DECK ONLY